



# KMCT COLLEGE OF NURSING

Recognized by Indian Nursing Council & Kerala Nurses and  
Midwives Council & affiliated to Kerala University of Health Sciences

## TO WHOMSOEVER IT MAY CONCERN

This is to certify that the information in the attached documents is verified by me  
and it is true to the best of my knowledge .

*Alahewi*



---

**KMCT Medical College Campus, Manassery, Mukkom, Kozhikode-673602, Kerala**

Phone: +91 495 2293040, Fax: +91 495 2295040

Email: [nursing@kmct.edu.in](mailto:nursing@kmct.edu.in) Website: <https://www.kmctnursingcollege.org/>



**KMCT**  
COLLEGE OF NURSING

Recognized by Indian Nursing Council & Kerala Nurses and  
Midwives Council & affiliated to Kerala University of Health Sciences

### 7.1.6

## GREEN CAMPUS INITIATIVES OF THE INSTITUTION



---

**KMCT Medical College Campus, Manassery, Mukkom, Kozhikode-673602, Kerala**

Phone: +91 495 2293040, Fax: +91 495 2295040

Email: [nursing@kmct.edu.in](mailto:nursing@kmct.edu.in) Website: <https://www.kmctnursingcollege.org/>

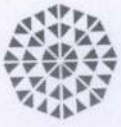

**KMCT**  
COLLEGE OF NURSING

Recognized by Indian Nursing Council & Kerala Nurses and  
Midwives Council & affiliated to Kerala University of Health Sciences

---

**7.1.6**

**GEOTAGGED PHOTOS OF THE  
FACILITIES**

*Habeed*





# KMCT COLLEGE OF NURSING

Recognized by Indian Nursing Council & Kerala Nurses and  
Midwives Council & affiliated to Kerala University of Health Sciences

## Restricted Entry of Automobiles



*Mohan*

**KMCT Medical College Campus, Manassery, Mukkom, Kozhikode-673602, Kerala**

Phone: +91 495 2293040, Fax: +91 495 2295040

Email: [nursing@kmct.edu.in](mailto:nursing@kmct.edu.in) Website: <https://www.kmctnursingcollege.org/>



# KMCT COLLEGE OF NURSING

Recognized by Indian Nursing Council & Kerala Nurses and  
Midwives Council & affiliated to Kerala University of Health Sciences

## 7.1.6

### Electric vehicle

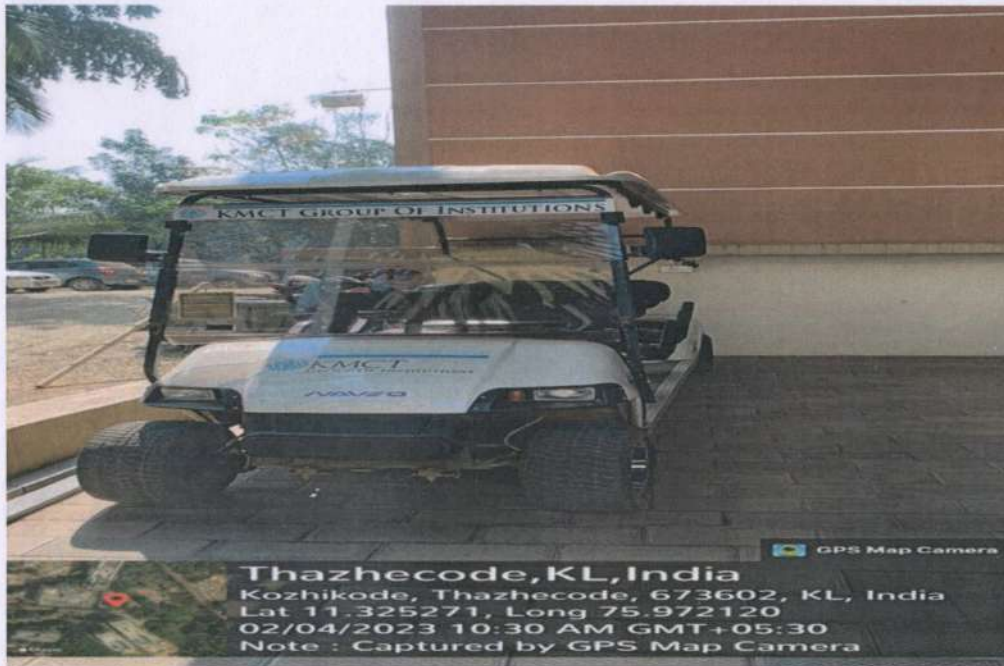

*Slabhan*

**KMCT Medical College Campus, Manassery, Mukkom, Kozhikode-673602, Kerala**

Phone: +91 495 2293040, Fax: +91 495 2295040

Email: [nursing@kmct.edu.in](mailto:nursing@kmct.edu.in) Website: <https://www.kmctnursingcollege.org/>





# KMCT

## COLLEGE OF NURSING

Recognized by Indian Nursing Council & Kerala Nurses and  
Midwives Council & affiliated to Kerala University of Health Sciences

### 7.1.6

## GREEN CAMPUS INITIATIVES OF THE INSTITUTION

### PEDESTRIAN-FRIENDLY PATHWAYS

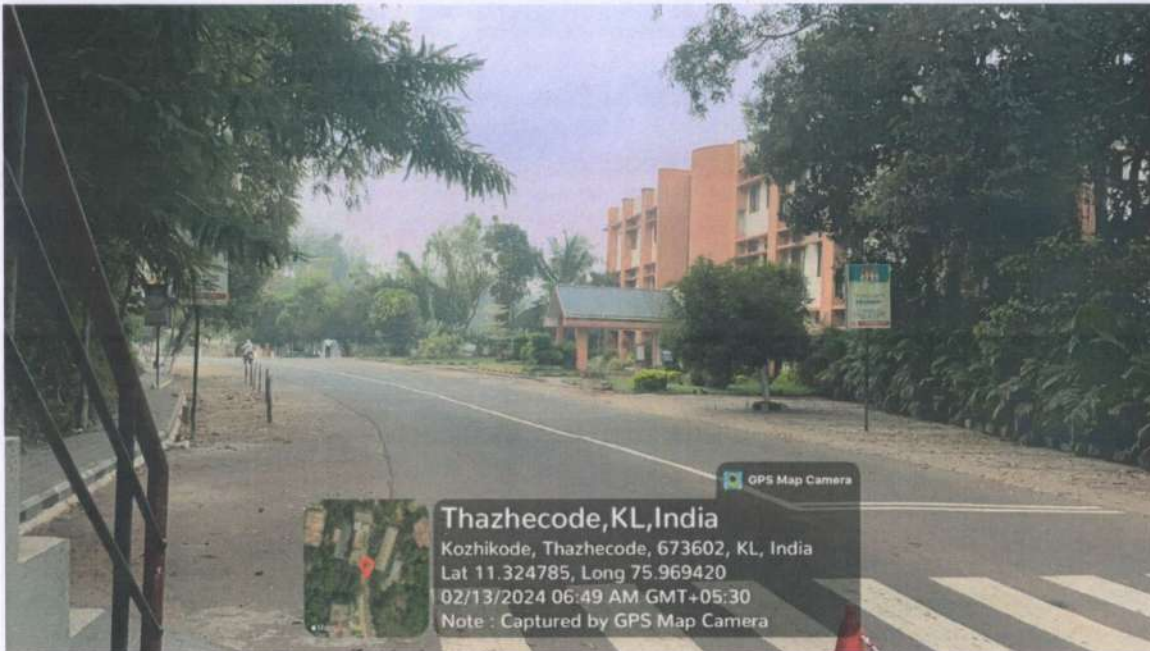

*Habaw*

KMCT Medical College Campus, Manassery, Mukkom, Kozhikode-673602, Kerala

Phone: +91 495 2293040, Fax: +91 495 2295040

Email: [nursing@kmct.edu.in](mailto:nursing@kmct.edu.in) Website: <https://www.kmctnursingcollege.org/>



# KMCT

## COLLEGE OF NURSING

Recognized by Indian Nursing Council & Kerala Nurses and  
Midwives Council & affiliated to Kerala University of Health Sciences

7.1.6

### GREEN CAMPUS INITIATIVES OF THE INSTITUTION

#### LANDSCAPING WITH TREES



*alabeu*

KMCT Medical College Campus, Manassery, Mukkom, Kozhikode-673602, Kerala

Phone: +91 495 2293040, Fax: +91 495 2295040

Email: [nursing@kmct.edu.in](mailto:nursing@kmct.edu.in) Website: <https://www.kmctnursingcollege.org/>



# KMCT COLLEGE OF NURSING

Recognized by Indian Nursing Council & Kerala Nurses and  
Midwives Council & affiliated to Kerala University of Health Sciences

## Ban on Use of Plastics

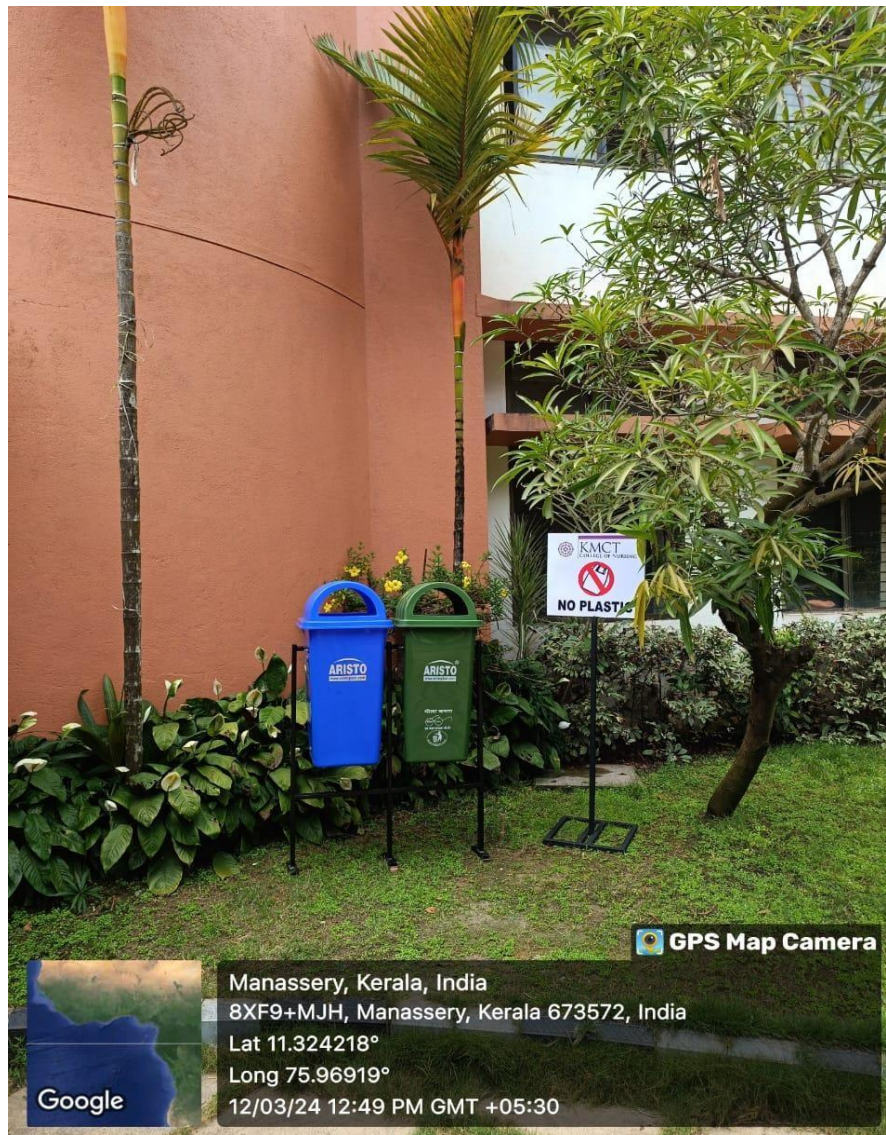

**KMCT Medical College Campus, Manassery, Mukkom, Kozhikode-673602, Kerala**

Phone: +91 495 2293040, Fax: +91 495 2295040

Email: [nursing@kmct.edu.in](mailto:nursing@kmct.edu.in) Website: <https://www.kmctnursingcollege.org/>





# KMCT COLLEGE OF NURSING

Recognized by Indian Nursing Council & Kerala Nurses and Midwives Council & affiliated to Kerala University of Health Sciences

## 7.1.6 LANDSCAPING WITH TREES



### LANDSCAPING PLAN

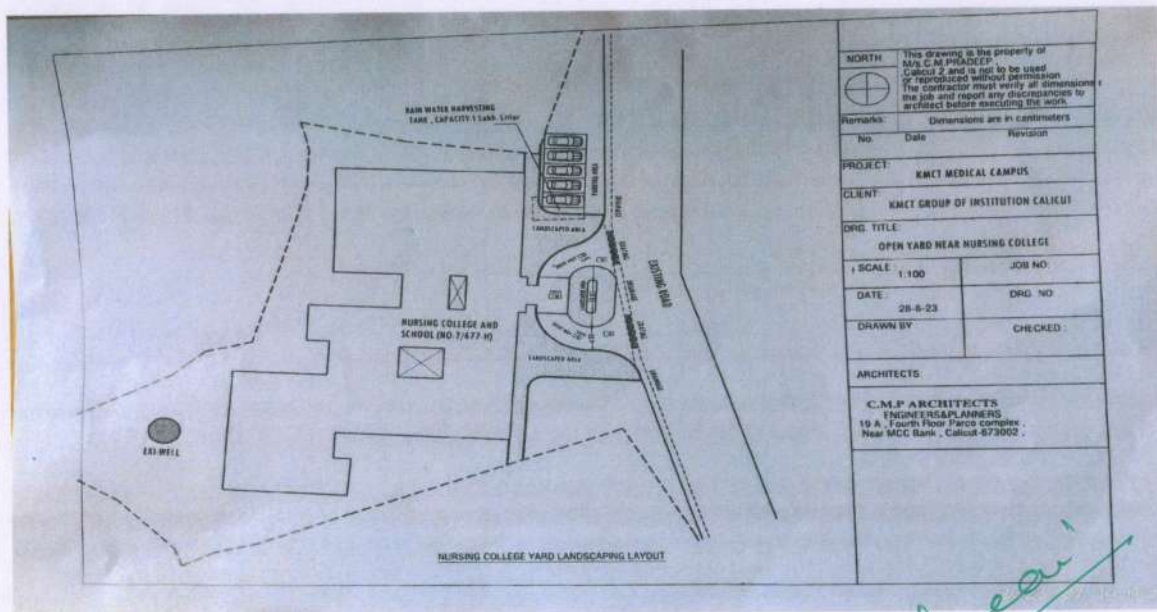

*Mohini*

KMCT Medical College Campus, Manassery, Mukkom, Kozhikode-673602, Kerala

Phone: +91 495 2293040, Fax: +91 495 2295040

Email: [nursing@kmct.edu.in](mailto:nursing@kmct.edu.in) Website: <https://www.kmctnursingcollege.org/>

